



Highmasts & Poles



HIGHMASTS

High mast lighting as a concept in area lighting is being preferred over conventional lighting, especially where large areas are to be illuminated without the need for numerous lighting columns that, under certain circumstances, can be a hazard to movement. This is possible because the high mast lighting system achieves very large space to height ratios.

High-mast lighting is ideal for many areas, particularly complicated or multi-level road systems, industrial or commercial areas, docks, airports, stations, car parks and even some hazardous areas. All of these areas require the best possible lighting with minimum interference from the installation itself combined with ease of maintenance.

Crompton Greaves with its pioneering position in the field of artificial illumination since last three decades is fully geared to meet the growing need for high mast lighting. Equipped with a fully qualified team of experience professionals Crompton Greaves has successfully executed numerous highmast lighting projects, right from offering best illumination design schemes to supply of superior quality poles lamps and luminaires/accessories.

STREET LIGHTING POLES

With the passage of time the concept of Street lights have under gone a major transformation. From being merely functional elements satisfying illumination requirements during the night time, it now doubles up as street furniture during the day time. The street lighting poles are also contributing immensely to the beauty and character of the changing cityscape. To reduce the clutter on the streets the street lighting poles, today, are also being designed for various street functions such as, traffic signs, street names, advertisement banners, CCTV cameras etc. Crompton Greaves has endeavoured to make the city roads and highways beautiful by introducing a whole new range of street poles and mounting brackets. City planners, civic authorities, engineers, contractors and consultants would find these to be appealing long term solution for well illuminated and congestion free streets.

Crompton Greaves can also supply galvanised arm brackets along with spigots matching with different types of poles and as per customer requirements. Typical arrangement and dimensional details for single arm and double arm bracket along with spigot suitable for different types of poles given below.



LAMP POST TECHNICAL DRAWING

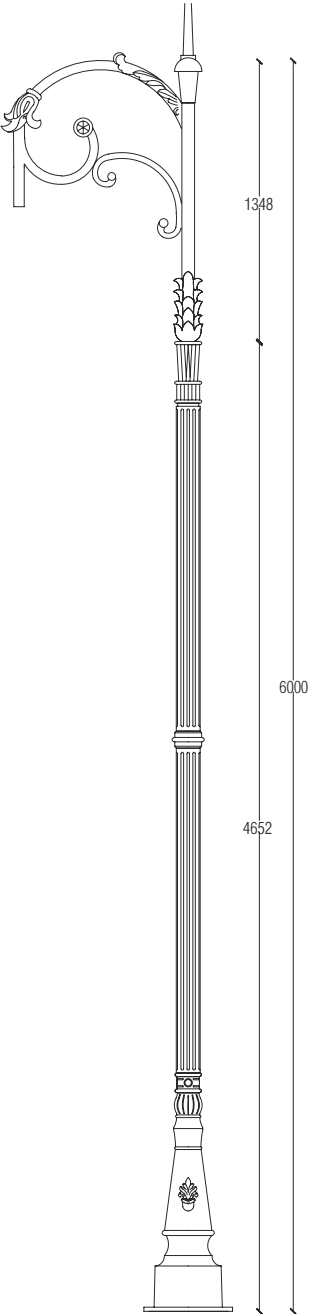

DLP-3-60-301-CG

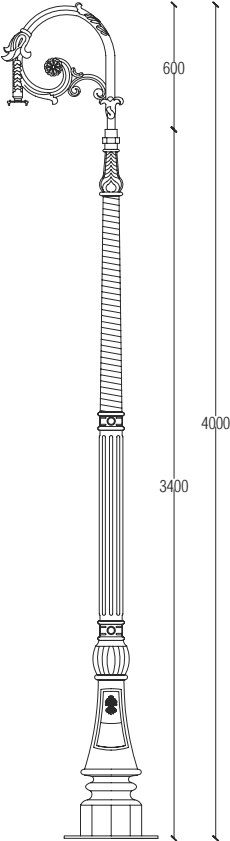

DLP-2-35-201-CG

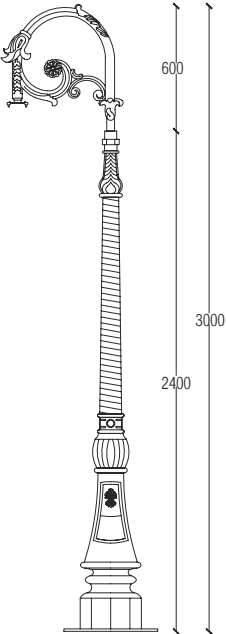

DLP-2-25-201-CG

DECORATIVE POLE DRAWING

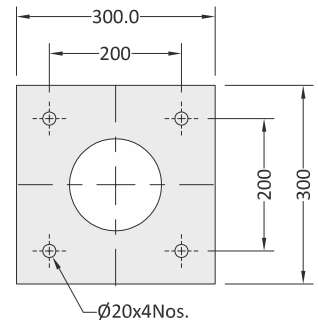
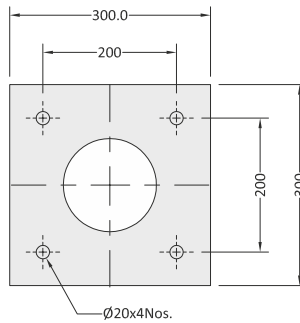
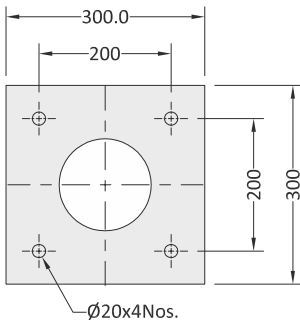
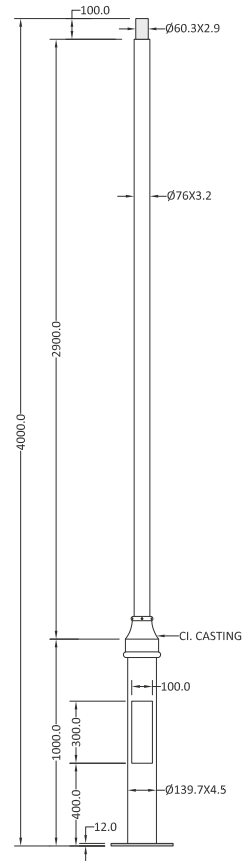
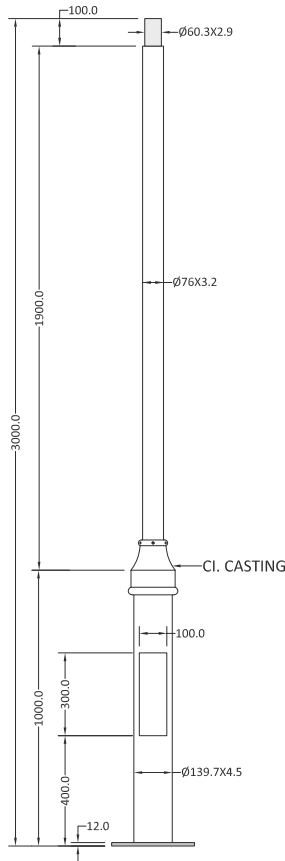
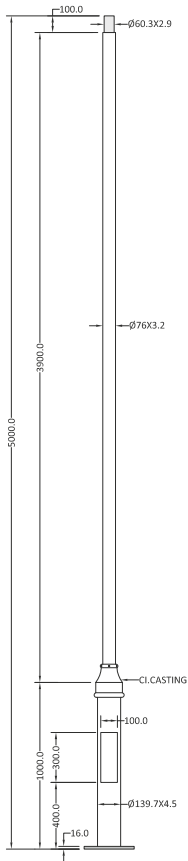



Street Light Automation

The key to next generation street lighting

Controls City Street Light
with a click of mouse



1W saved =
1.5W generated

System Features

- Ease of installation with wireless (GPRS) connectivity to data server
- Web based SCADA for controlling, Monitoring and Configuration.
- Astronomical Timer based ON-OFF
- Ambient Light intensity based On-Off using IR sensing.
- Customised Load voltage regulation level.
- Energy saving upto 50% through Dimming and load Control Schemes
- Time synchronization with the server.
- Instant fault reporting via SMS along with the probable fault details.
- Event and fault Logging
- Customizable MIS report generation
- GIS (Geographical Information System) interface to show location of

installation and status.

Benefits

- Centralized monitoring and control solution
- Energy saving through:
 - ON-OFF synchronization with ambient light intensity
 - Dimming
 - Load voltage regulation (line voltage > 230V)
- Improved life of components (lamps, electro-magnetic ballasts, etc.)
- Less turn around time in case of fault due to instant alarms
- Web interface for remote operation.

Applications

- Municipal Corporations • Highways • Industrial Complex
- Housing Complex • Institute Campus • Border Security

PIR SENSORS

	CAT REF.	WATTAGE	CASE LOT	ALP (₹)
	DIGITAL PIR SENSOR WITH DIMMING #			
	K4029	PIR	-	17630.00
Digital PIR sensor with Occupancy & active photocell for Analogue dimming - Flush mount.				
	DIGITAL PIR SENSOR WITH DIMMING #			
	K4024	PIR	-	21900.00
Digital PIR sensor with Occupancy & active photocell for DALI dimming - Flush mount.				
	DIGITAL PIR SENSOR WITH DIMMING #			
	K4019	PIR	-	11420.00
Digital PIR sensor with Occupancy & active photocell for DSI/DALI dimming - Flush mount.				
	HF SENSOR #			
	K4030	HF	-	16000.00
Recessed mounted High Frequency Sensor.				
	ANALOG PIR SENSOR #			
	K5015	PIR	-	6270.00
	K5016	PIR	-	6270.00
Analog PIR sensor with Occupancy & passive photocell for switching output. K5015 : Flush mounted K5016 : Surface mounted				
	DIGITAL PIR SENSOR #			
	K4015	PIR	-	8410.00
	K5016	PIR	-	6270.00
Digital PIR sensor with occupancy & active photocell for switching output - Slimline Flush mount.				

Please contact local CROMPTON representative for price details. Normal policy not applicable.

LIGHTING MANAGEMENT SYSTEM

CAT REF.	No. of Channels	Type of Channels	ALP (₹)
CONTROLITE - LIGHTING MANAGER			
LMAA50KB01	6	4 DALI + 2 ON/OFF	On Request
LMBB50KB01	6	4 DSI + 2 ON/OFF	On Request
LMCC50KB01	6	4 ANALOG + 2 ON/OFF	On Request
LMAB50KB01	6	2 DALI + 2DSI + 2 ON/OFF	On Request
LMAC50KB01	6	2 DALI + 2 ANALOG + 2 ON/OFF	On Request
LMBC50KB01	6	2 DSI + 2 ANALOG+ 2 ON/OFF	On Request



Compact lighting scene controller for conference room, meeting room.
 Four dimming channel support : 1-10 V, DSI, DALI & 2 nos of ON/OFF channel.
 Create 16 scenes with the help of 6 groups.
 Digital power output upto 800 VA per channel.
 Infra red remote control.
 Additional 1no DALI power supply is required for 2 nos DALI channel support.



The Premier Design Award for Product Design in India

